

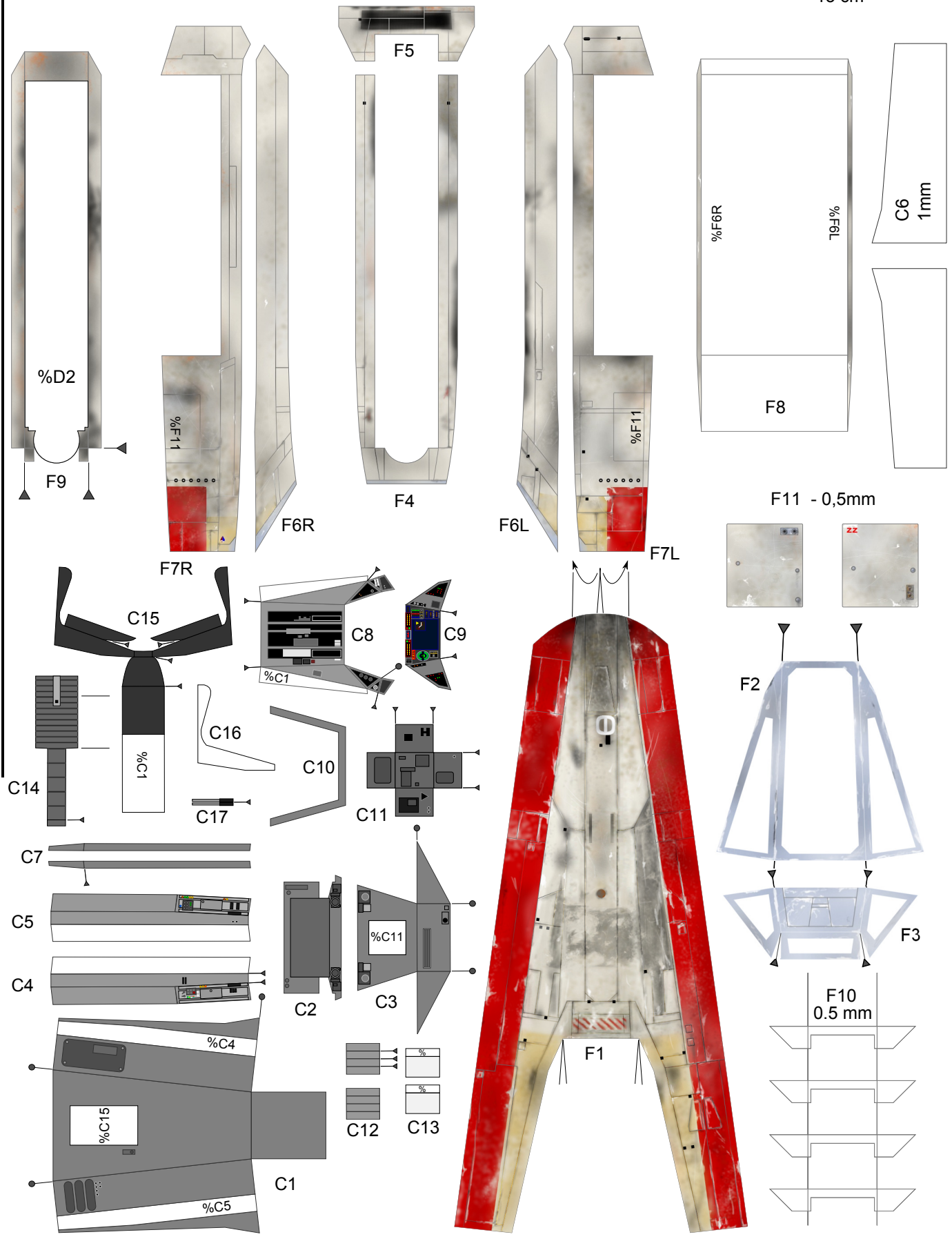

15 cm

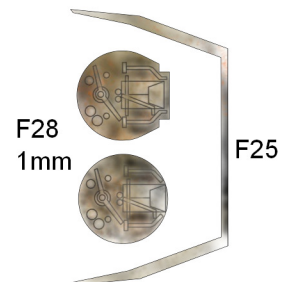

15 cm

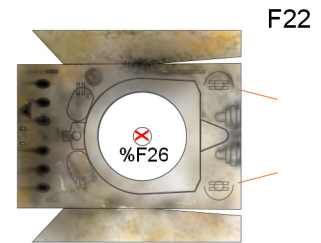
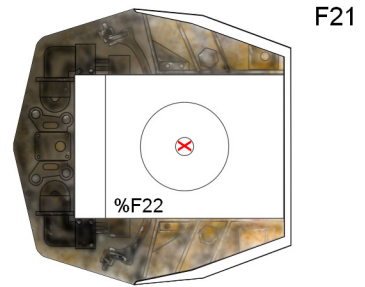
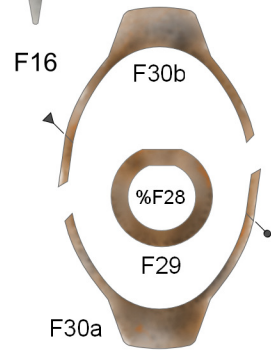
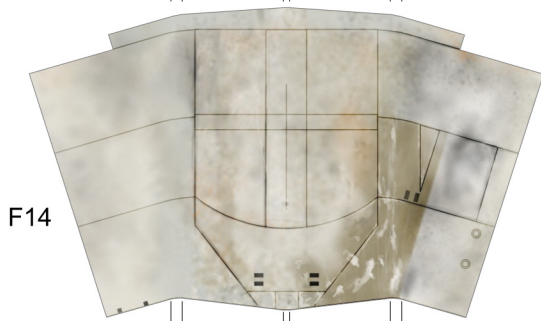
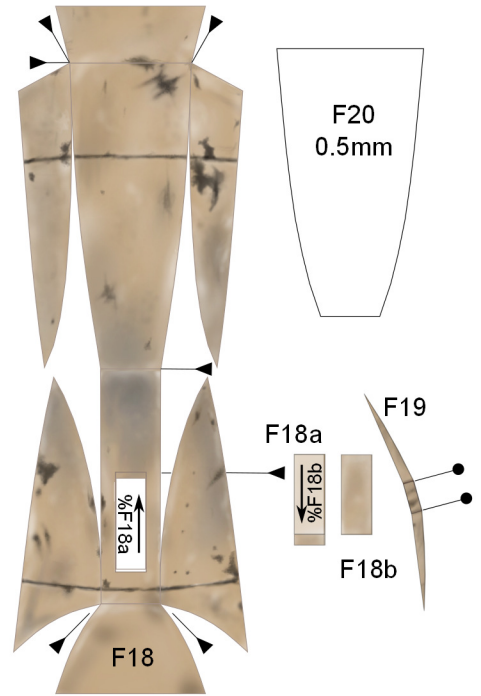
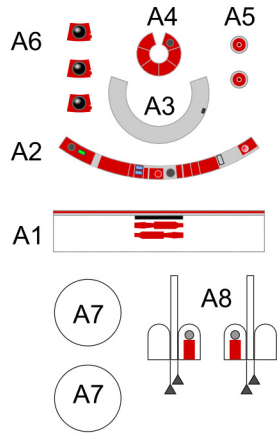
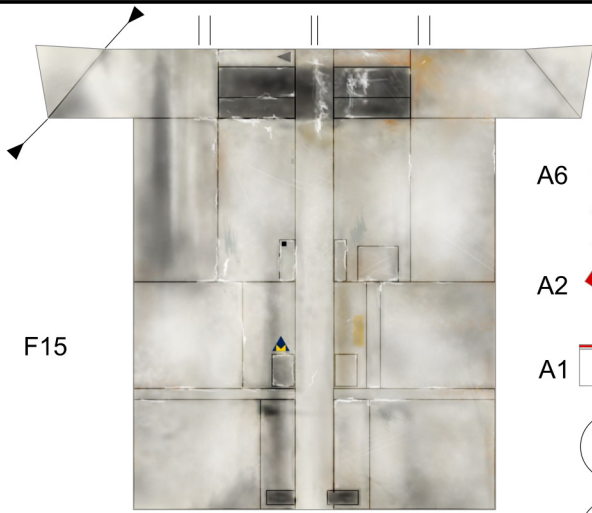

15 cm

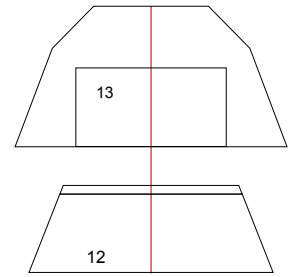
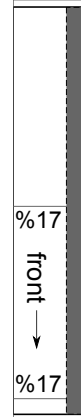
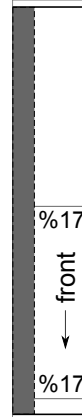
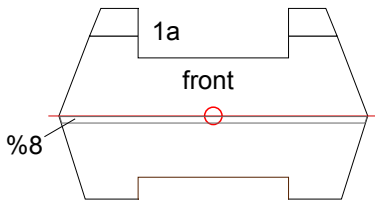
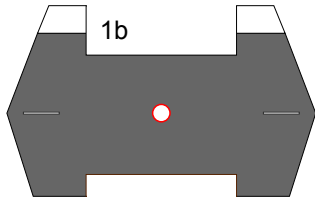
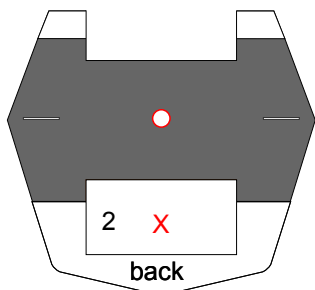

Recommended paper thickness:  
1mm: parts 1b, 2, 3, 4, 5  
0,5 or 1mm: part 8a  
0,5mm: parts 9, 11-17

7R

7L

6L

6R

3L

3R

8a,b - cut according to the thickness of part 1

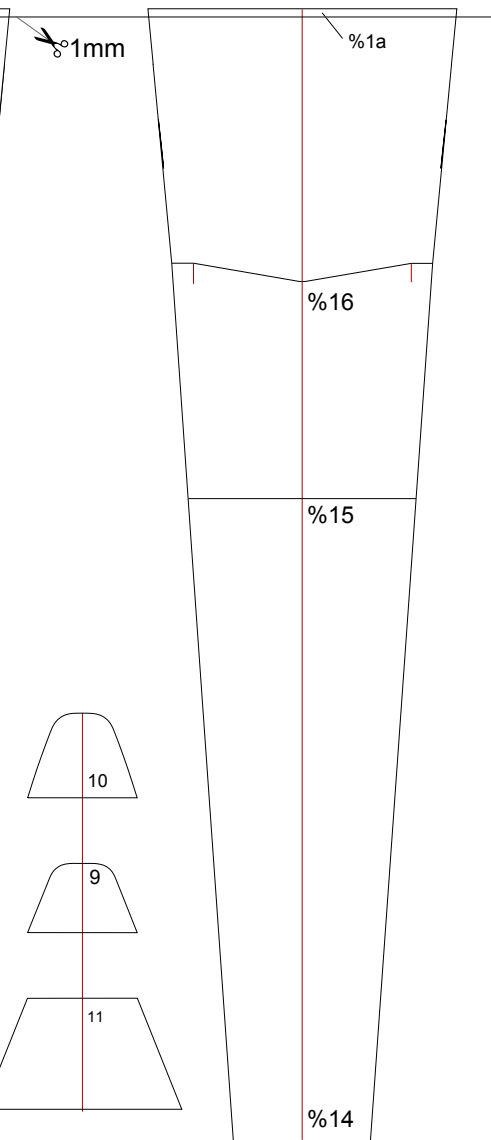
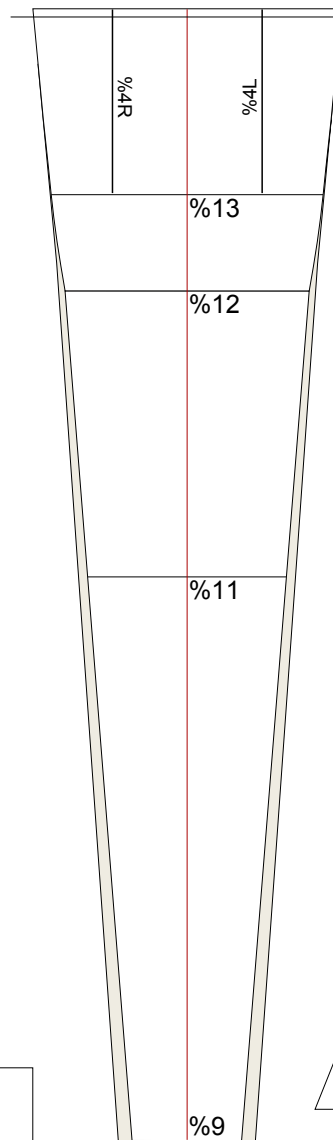
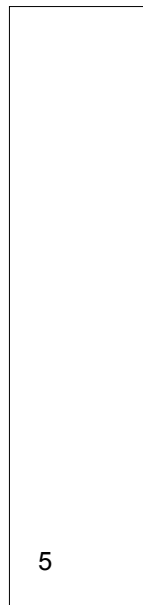

1 mm ? 0.5 mm

cut according to the thickness of part 8



profile

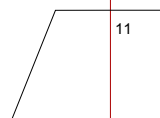
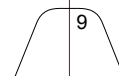
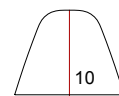
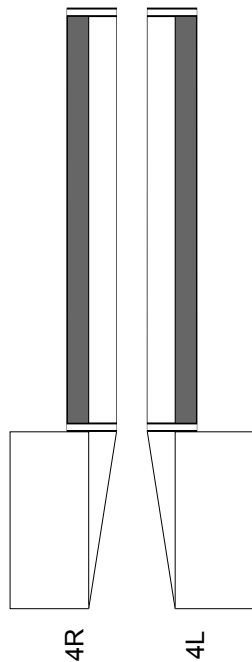

cut according to the thickness of part 7

0.5 mm

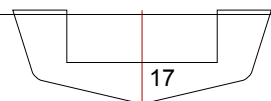
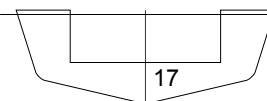

15 cm

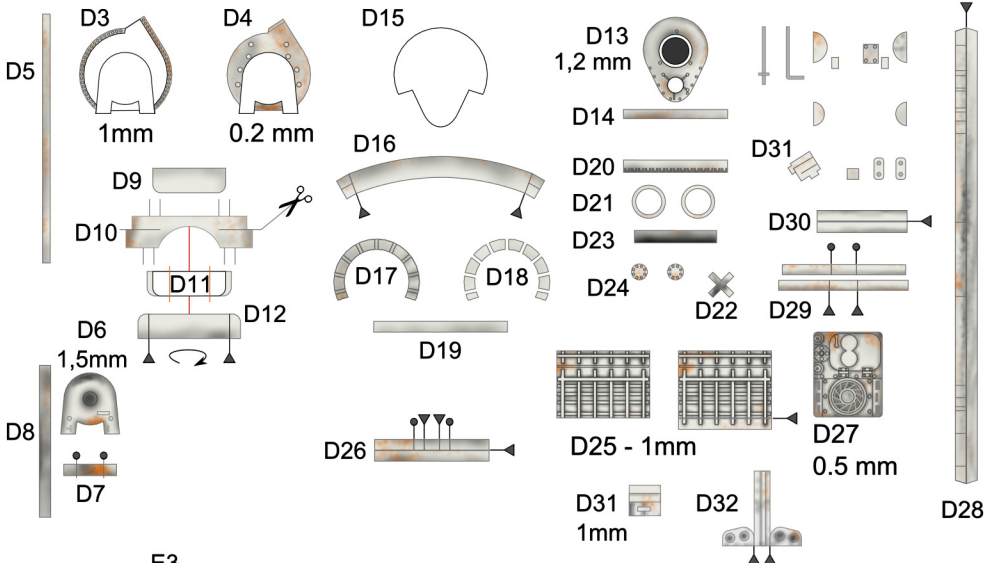

D2  
0.5 mm

X-Wing paper model by David Petthes,  
2011-12-2012.  
Original design by ILM.  
Special thanks to George Lucas.

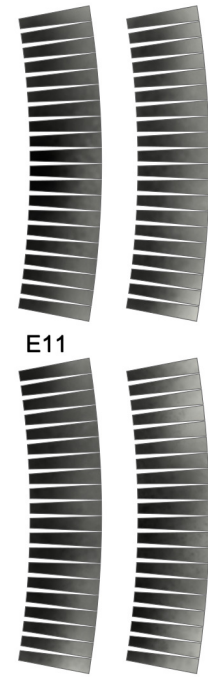
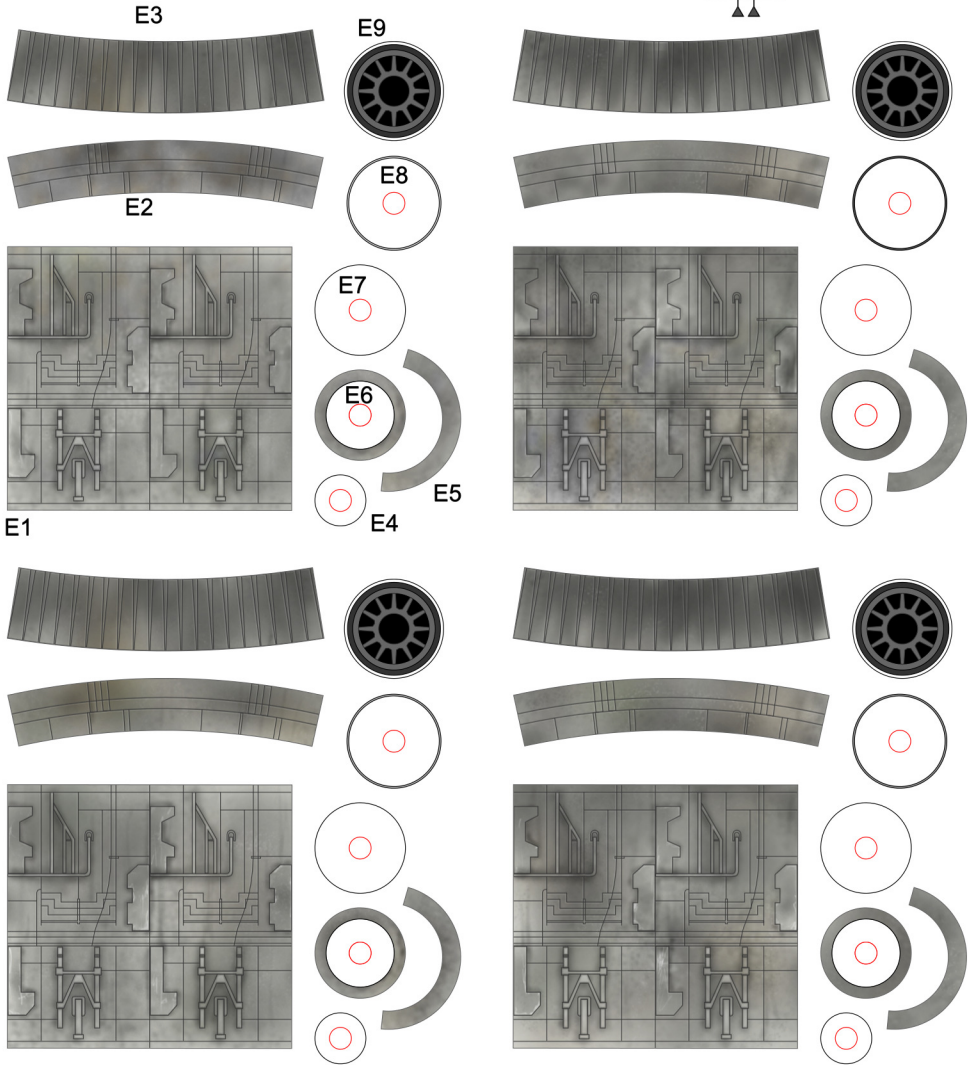

E10

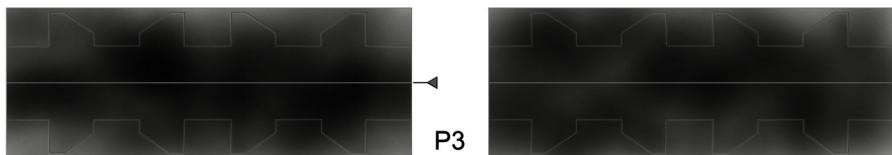

P3

Model is freely available at <http://xwingpm.wz.cz>  
or <http://imcold.evilhosting.org>  
Not for sale or another commercial usage.  
Do not redistribute or modify. Thanks!  
Released on 30.12.2012

15 cm

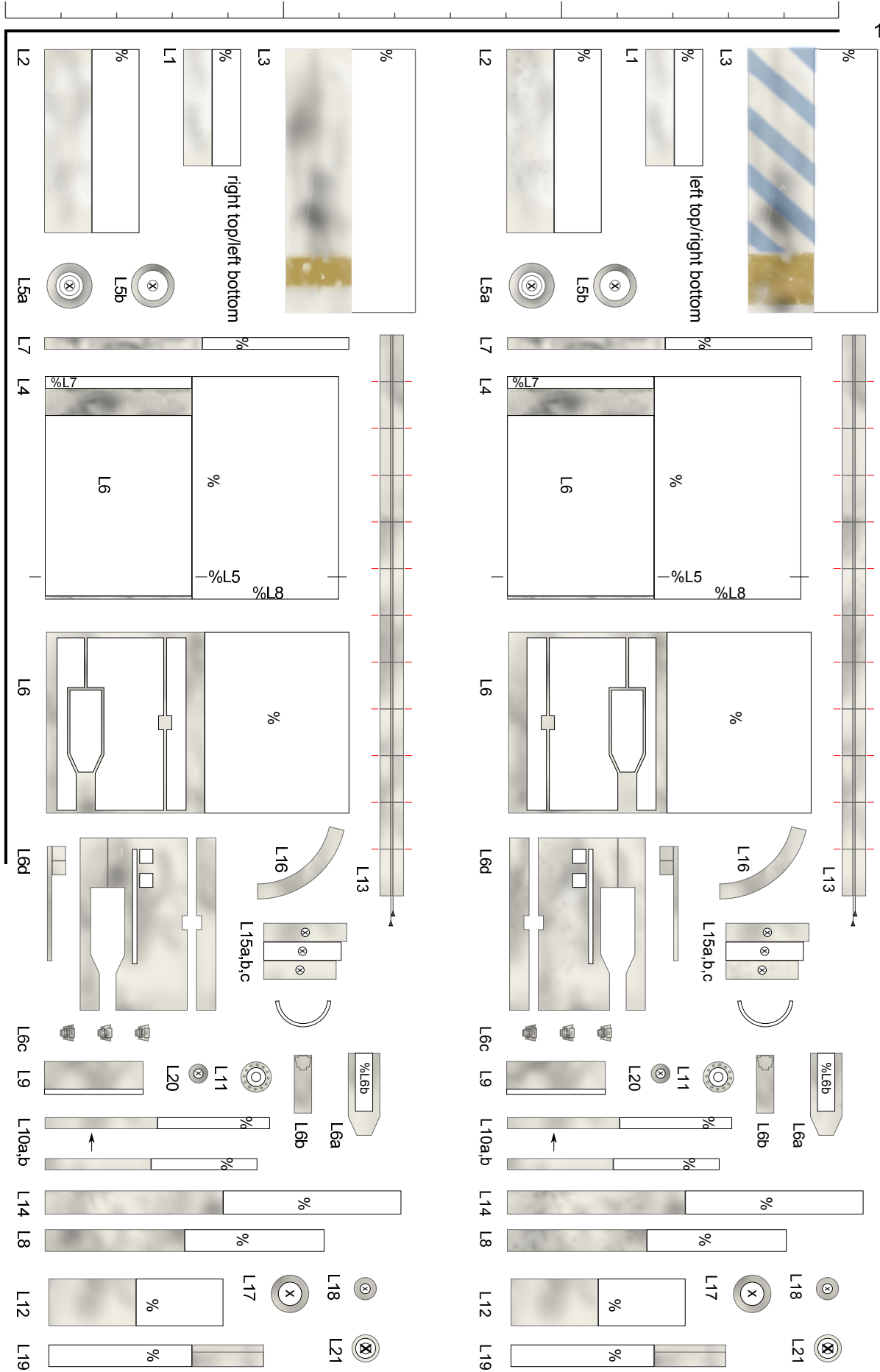

15 cm

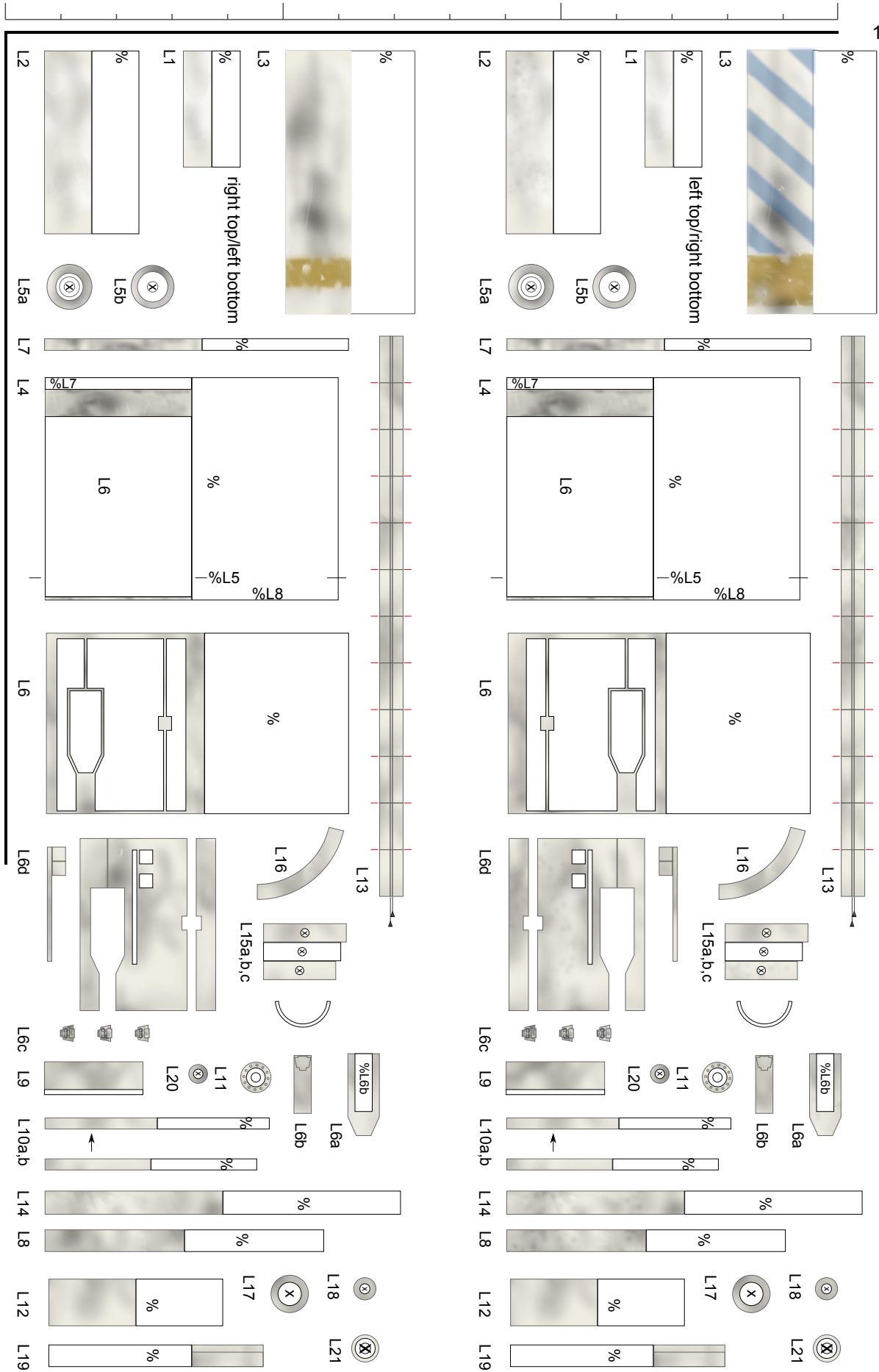

right top /  
left bottom

15 cm

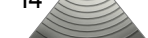
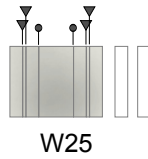
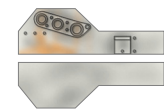

W26

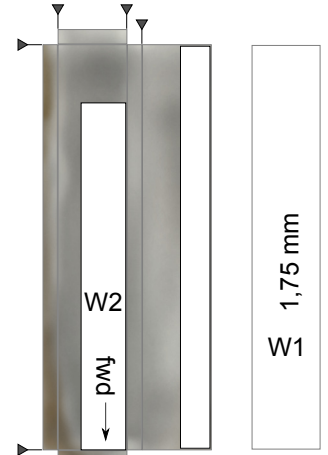
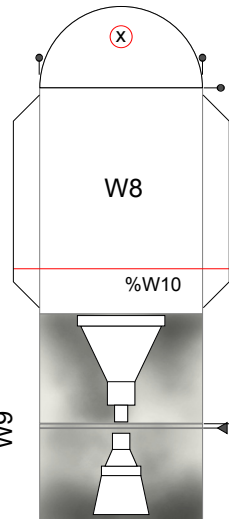
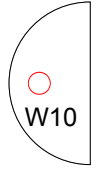
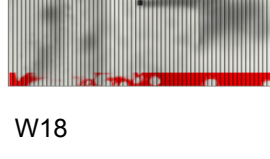
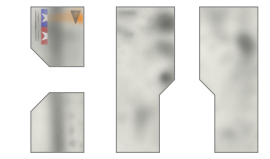
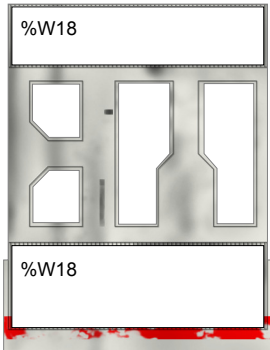
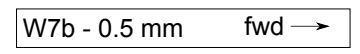
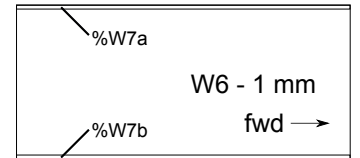
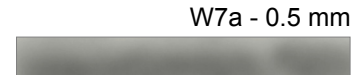

W13



W19

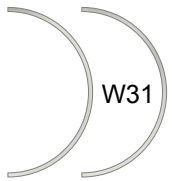
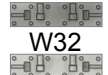
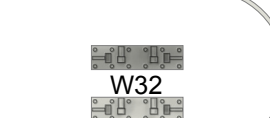

W28 - 0.5mm

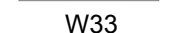
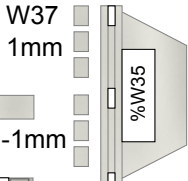
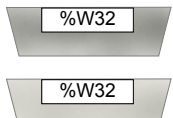
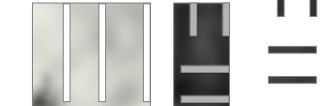

W36 - 1mm

W33

W35 0.5mm

W34 0.3mm

W38

W33

W35 0.5mm

W34 0.3mm

W38

W33

W35 0.5mm

W34 0.3mm

W38

W33

W35 0.5mm

W34 0.3mm

W38

W33

W35 0.5mm

W34 0.3mm

W38

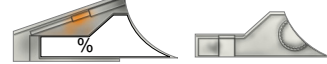
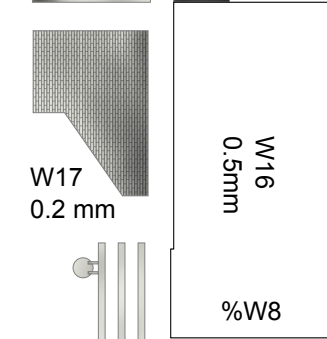

W15 - 0.2 mm



D. Pethes, 2011

P1 - 0.5mm

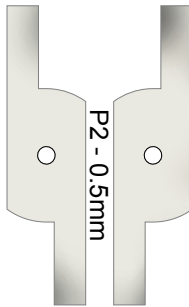

P2 - 0.5mm



W39

right top /  
left bottom

15 cm

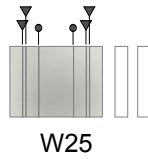
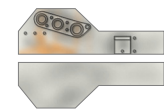

W26

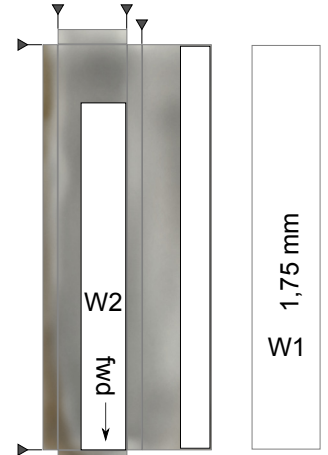
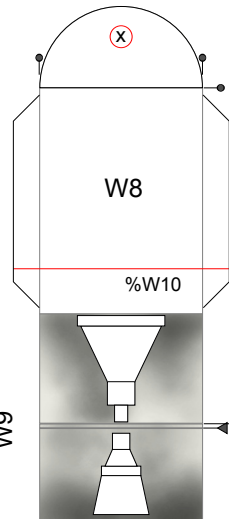
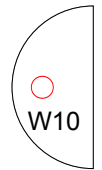
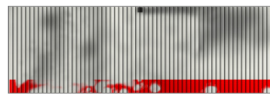
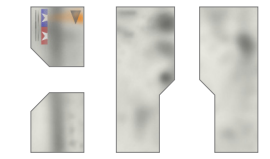
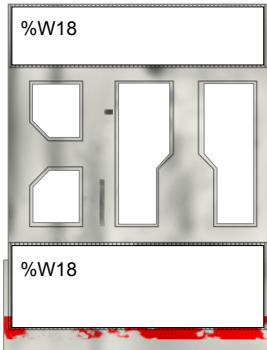
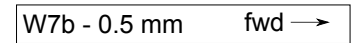

W13



W18



W20



W19

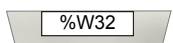
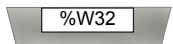
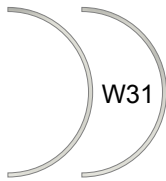

W33

W37 1mm



W36 -1mm

W35 0.5mm

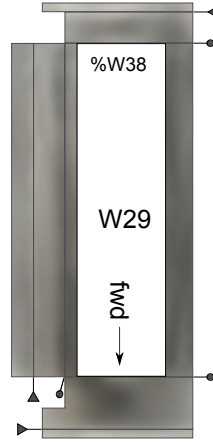

W28 - 0.5mm

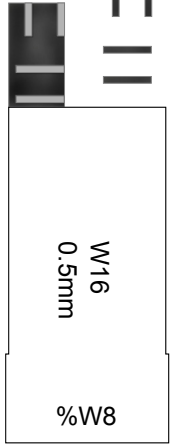
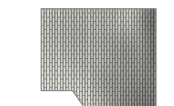

D. Pethes, 2011

P1 - 0.5mm

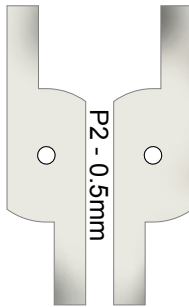

P2 - 0.5mm

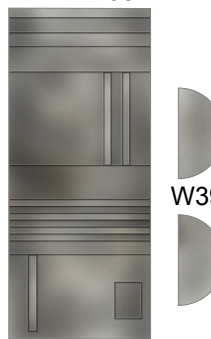

W3 - 1mm

W15 - 0.2 mm



W30 - 0.5mm



15 cm

LEFT TOP

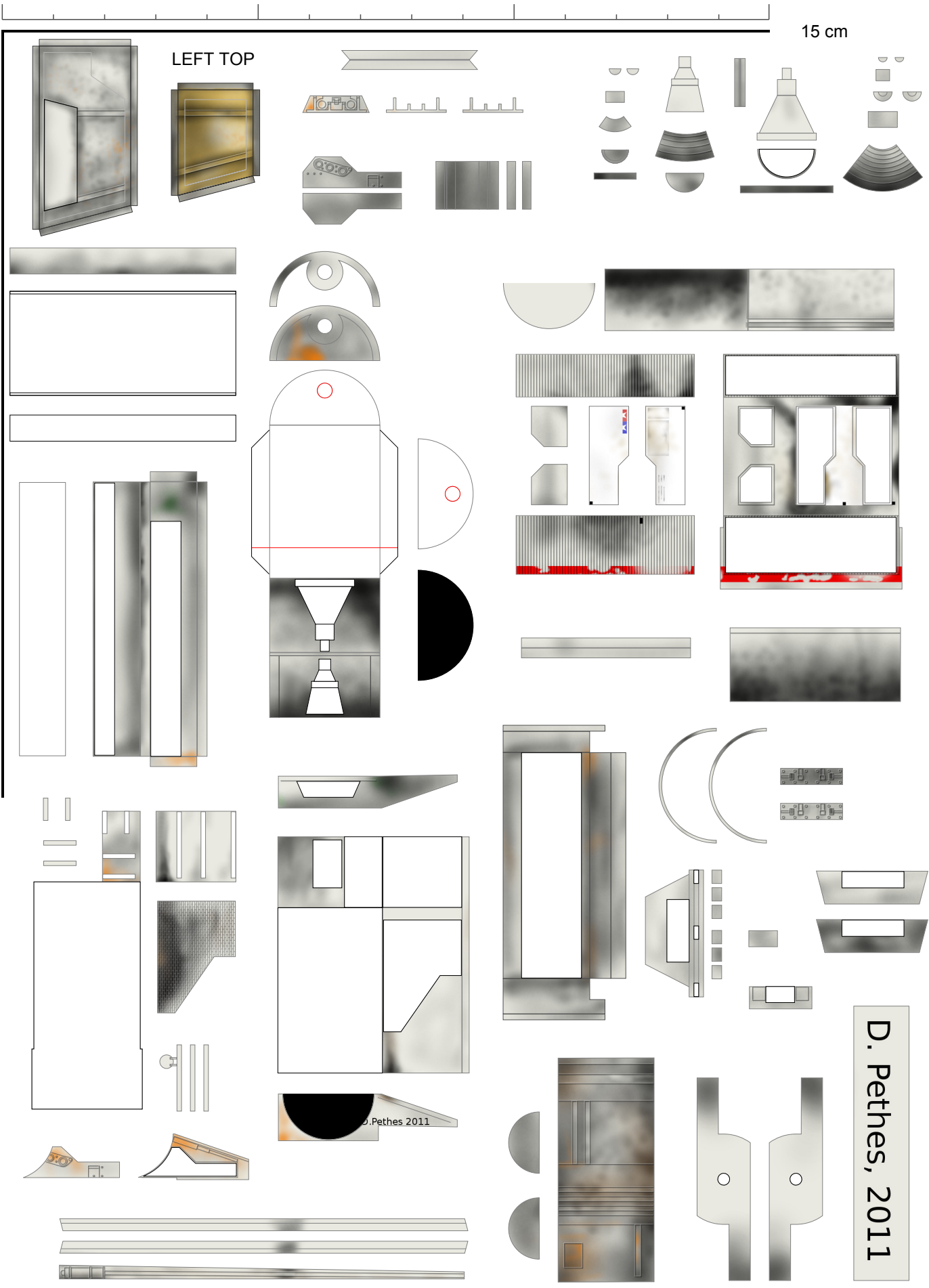

D. Pethes, 2011

15 cm

LEFT TOP

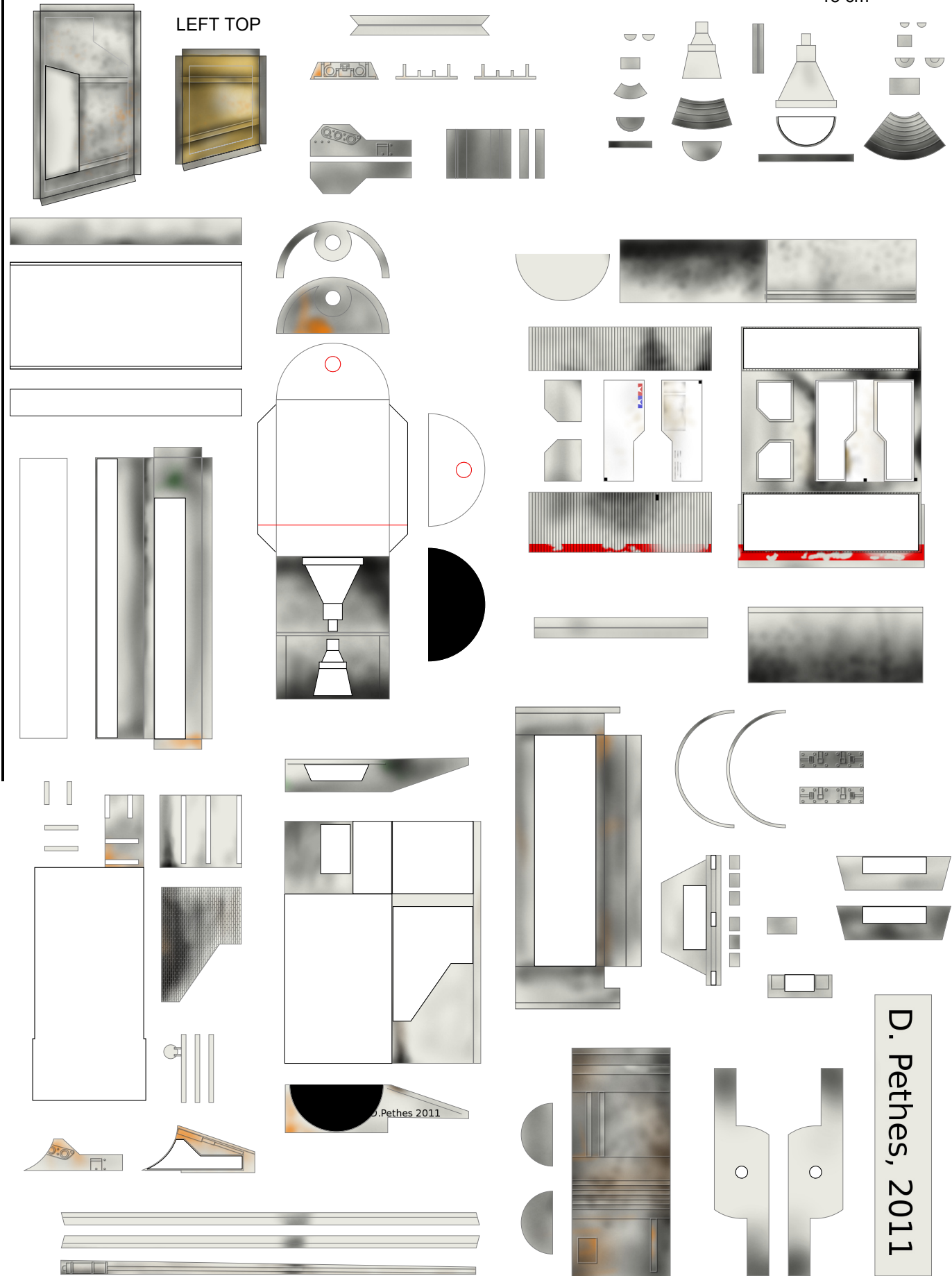

D. Pethes 2011

D. Pethes, 2011

15 cm

W14

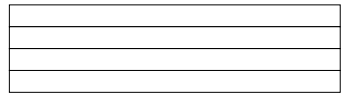
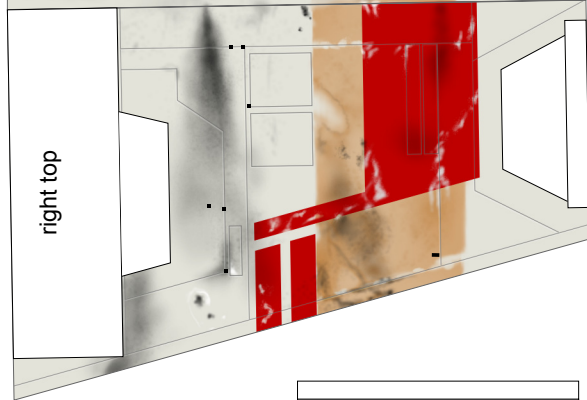
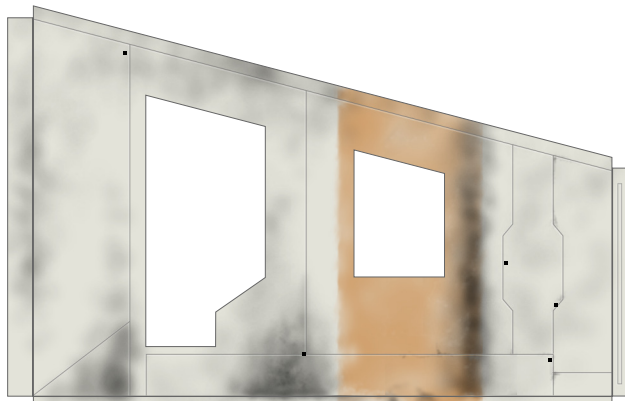
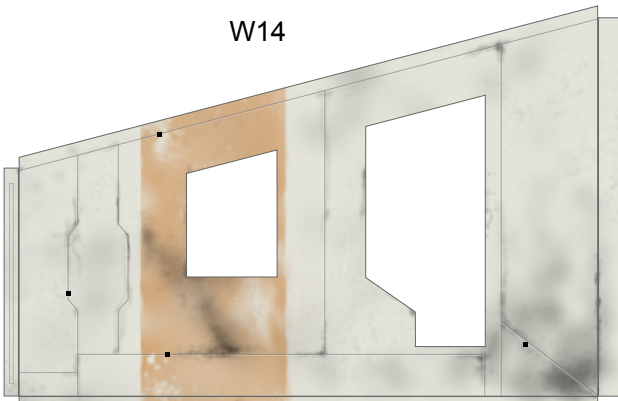

WF3

WF4

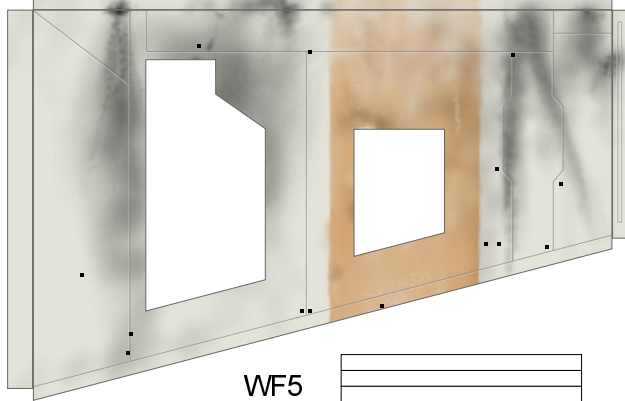
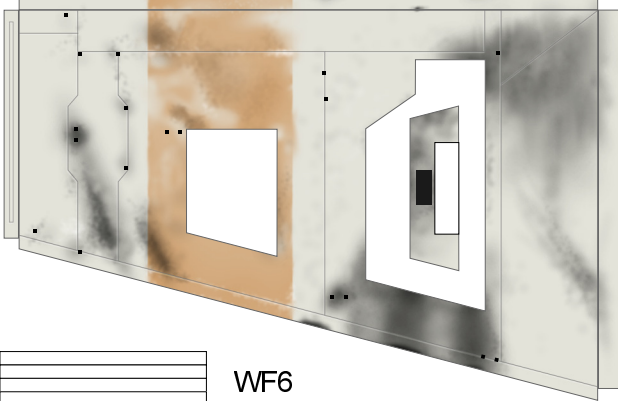
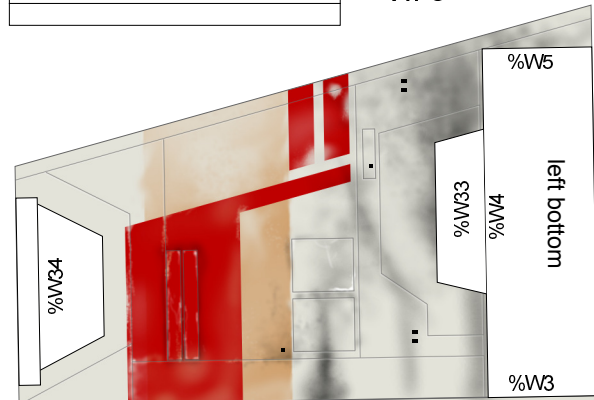
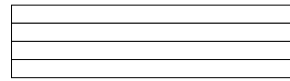

WF6

WF5

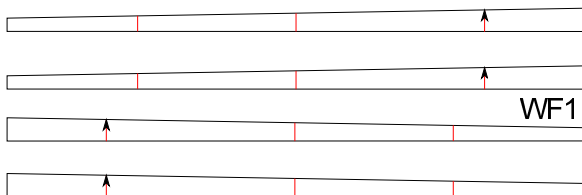
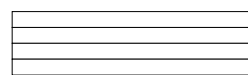

WF1

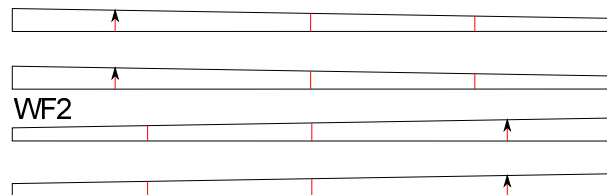

WF2